

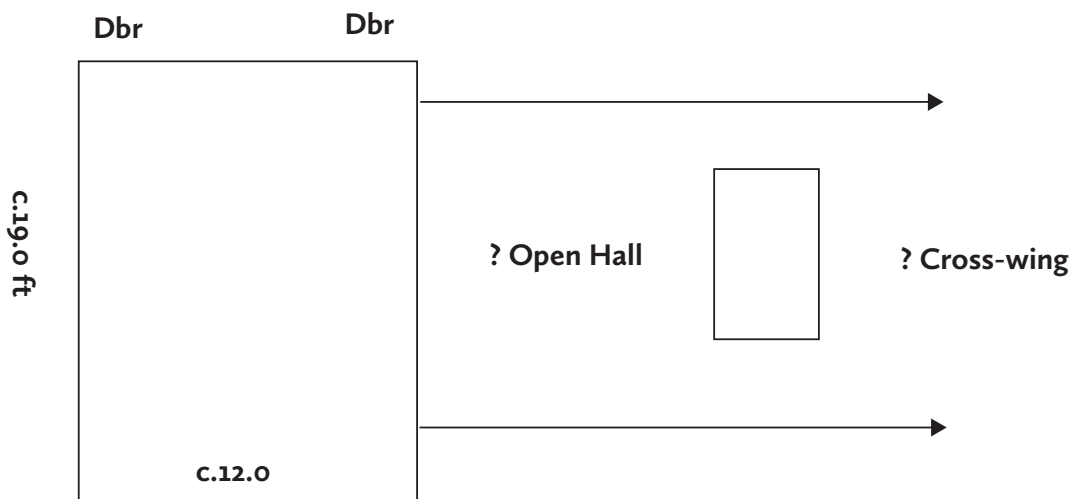

16 Bones Lane

From external observation, the visible framing at the rear of No 16 is clearly of a cross-wing (of at least two bays) to a medieval open hall and a further floored element, which should be contained within No 15. The ridge over No 15 is higher south of the chimney stack, which may be indicative of a second wing. The framing visible to the rear of No 16 suggests the two parts were originally a single house of some quality, but this could only be confirmed by interior inspection.



The listing did record some of the important features (bold type) but was limited by the state of knowledge in the 1950s.

Statutory listing:

Nos 15 and 16 (Thatch) BONES LANE
1954 Gil

Two cottages. Late-medieval timber-framed hall with crosswings (?) refaced C18, and with C20 extensions. Main walls of ashlar malmstone with brick dressings, part being roughcast: C20 rear and side extensions, one of brickwork and the other of conforming malm-

stone : the rear wall of one of the wings (No 16) has exposed framing, bricknogged. Thatch roof, of different ridge levels, with hips and half-hips, brought to a lower eaves in the middle, with a tile roof above a ground floor forward extension (between the wings). Irregular front (south-west) of two storeys, 1.1.1 above 2.2 windows. Sashes, also casements, one being a small leaded upper window in the centre. Glazed porch to No 15, porch with a side entry to No 16.